



Box 28, Nesbitt, Manitoba R0K 1P0 Phone: (204) 824-2666 Fax: (204) 824-2374

**Public Works and Transportation Services Committee Meeting
May 21, 2019
Immediately following Council Meeting to 12:00 noon
Nesbitt Hall, Nesbitt MB**

1. Call to Order

2. Adoption of Agenda

BE IT RESOLVED that the May 21, 2019 agenda be accepted as presented.

3. Adoption of Minutes

BE IT RESOLVED that the Minutes of the March 5, 2019 minutes be approved as circulated.

4. General Business

Gravel Spreading Map

BE IT RESOLVED that a resolution be provided to Council that the 2019 gravel spreading map be approved.

Road Construction Map

BE IT RESOLVED that a resolution be provided to Council that the 2019 road construction map be approved.

Long-Term Road Construction Projects

BE IT RESOLVED that a resolution be provided to Council that the following list constitute a priority list for long-term road construction:

Green Aces Road continuation – build up road
Road 102W south of Road 38N – replace culvert and widen road crossing

Wawanesa Projects contained in 2019 Budget

Discussion only.

Waste Transfer Stations work contained in 2019 Budget

Discussion only.

Municipal Trucks

BE IT RESOLVED that a resolution be provided to Council that quotes be obtained for the purchase of a $\frac{3}{4}$ ton truck as per the specifications discussed at the Public Works and Transportation Services Committee Meeting.

BE IT RESOLVED that a resolution be provided to Council that the 2011 GMC $\frac{1}{2}$ ton truck be

5. Adjourn

BE IT RESOLVED that the meeting does now adjourn (time) to meet again at the call of the Chair.

Dave Kreklewich, Chair

Joni Swidnicki, Chief Administrative Officer

**Public Works and Transportation Services Committee Meeting
March 5, 2019
Immediately following Special Council Meeting
Nesbitt Hall, Nesbitt MB**

The members of the Public Works and Transportation Services Committee met at the Nesbitt Hall, on Tuesday, March 5, 2019 at 9:07 a.m. Members Present: Councillors Fowell, Hargreaves, McDonald, McGregor, and Sowiak. Head of Council Kreklewich presided.

Member absent: Councillor Rome

Staff in attendance: Chief Administrative Officer Joni Swidnicki and Public Works Manager Darcy Ketsman

1. Call to Order
2. Adoption of Agenda

McDonald-McGregor

BE IT RESOLVED that the March 5, 2019 agenda be accepted as presented. CARRIED.

3. General Business

Appointment of Chair

McDonald-McGregor

BE IT RESOLVED that a recommendation be provided to Council that Head of Council Dave Kreklewich be appointed as Chair of the Public Works and Transportation Services Committee. CARRIED.

Gravel Spreading

Hargreaves-Sowiak

BE IT RESOLVED that a recommendation be provided to Council that a rotational gravel spreading map be prepared based on 175 yards per mile on the heavy usage roads and an average of 100 yards per mile on the remaining roads. CARRIED.

Gravel Crushing

Hargreaves-McDonald

BE IT RESOLVED that a recommendation be provided to Council that a tender be prepared and advertised for the 2019 gravel crushing requirements subject to 2019 budget approval. CARRIED.

Summer Operations Policy

McGregor-Sowiak

BE IT RESOLVED that a recommendation be provided to Council that a Summer Operations Policy be prepared for consideration and adoption. CARRIED.

Group Community Projects

Discussion only.

Dust Control Policy

McDonald-Hargreaves

BE IT RESOLVED that a recommendation be provided to Council that a Dust Control Policy be prepared for consideration and adoption. CARRIED.

5-Year Road Rehabilitation Plan

McGregor-McDonald

BE IT RESOLVED that a recommendation be provided to Council that a 5-year road rehabilitation plan be prepared for consideration and adoption. CARRIED.

Surface Drainage and Tile Drainage Policy

Sowiak-McGregor

BE IT RESOLVED that a recommendation be provided to Council that a surface and tile drainage policy be prepared for consideration and adoption. CARRIED.

Approach Policy - Culvert/Drainage

Hargreaves-Sowiak

BE IT RESOLVED that a recommendation be provided to Council that the approach policy be amended to include culvert/drainage issues and application fees be amended accordingly. CARRIED.

4. Adjourn

Fowell-McDonald

BE IT RESOLVED that the meeting does now adjourn (12:05) to meet again at the call of the Chair. CARRIED.

Dave Kreklewich, Chair

Joni Swidnicki, Chief Administrative Officer



Transportation Committee Meeting

1. Gravel Spreading Map

- a. Review proposed gravel spreading program and provide feedback

2. Road Construction Map

- a. Red X's are locations of frost boils that have developed and require attention.
 - i. Propose to build up frost boil with shale and cap with gravel
 - ii. Estimated costs for all locations \$45,000
- b. Yellow Diamond's are locations that require culvert installations or replacements
 - i. An approach with a culvert is slated to be installed on Rd.108 north of 453 as part of a previous development agreement dating back to 2013. This work will be performed inhouse. Estimated costs for this project is \$800
 - ii. A new culvert will be installed on Rd.41N east of Rd.113 to replace a corroded and collapsed equalizer culvert. This work will be performed inhouse with costs estimated at \$1200
 - iii. A new equalizer culvert will be installed on Rd.41N west of Rd.111 to replace an existing culvert that is no longer functioning. This work will have be done by a contractor with costs estimated at \$2500
- c. Green Square is the stretch of Rd.106 from highway #2 to the entrance of the Cargill Elevator
 - i. Propose to apply a road stabilization product to this section of road to reduce maintenance requirements and degradation of the road from heavy traffic.
 - ii. Discussion and feedback
- d. Blue Square is a location on Rd.105 where there is an old wooden box culvert that is in need of attention
 - i. Propose to remove and replace with an appropriately sized culvert
 - ii. Requires a hydrologist report who can determine culvert sizing required.
 - iii. Estimated cost for this project could be \$10,000
- e. Green Triangle is the location of a new road that we need to build just east of the Co-op in Wawanese to fulfill previous land development obligations.
 - i. Estimated costs for completion of this project is \$2,000
- f. Red Squares are potential locations for dust control. Dust control sites may change depending on review of gravel spreading map.



Transportation Committee Meeting

- g. Purple highlighted roads are roads that the gravel reclaimer has completed.
- 3. Other potential road construction projects – Review and Discuss**
 - a. Green Acres Road – Continue building up road from previous project
 - b. Replace culvert on Rd.102W south of Rd.38N and widen road crossing
- 4. Wawanesa Projects – Review and Discuss**
 - a. Demolition of former waste treatment plant
 - b. Installation of new storm pipe below main/4th St.
 - c. Paving on Crescent, 1st St, Park St., Hospital Backlane and Commercial
- 5. Waste Transfer Stations**
 - a. Oakland WTS
 - i. Remove Shingles
 - ii. Build new safety fence for bins
 - iii. E-Waste
 - b. Wawanesa WTS
 - i. Install new gate for entrance
 - ii. Widen approach/entrance to site
 - iii. Landscape areas prone to collect water
- 6. Municipal Trucks**
 - a. Review specifications and discuss

22 miles @ 175 yds/mile
26 miles @ 100 yds/mile
RGE. 17 W.P.M.

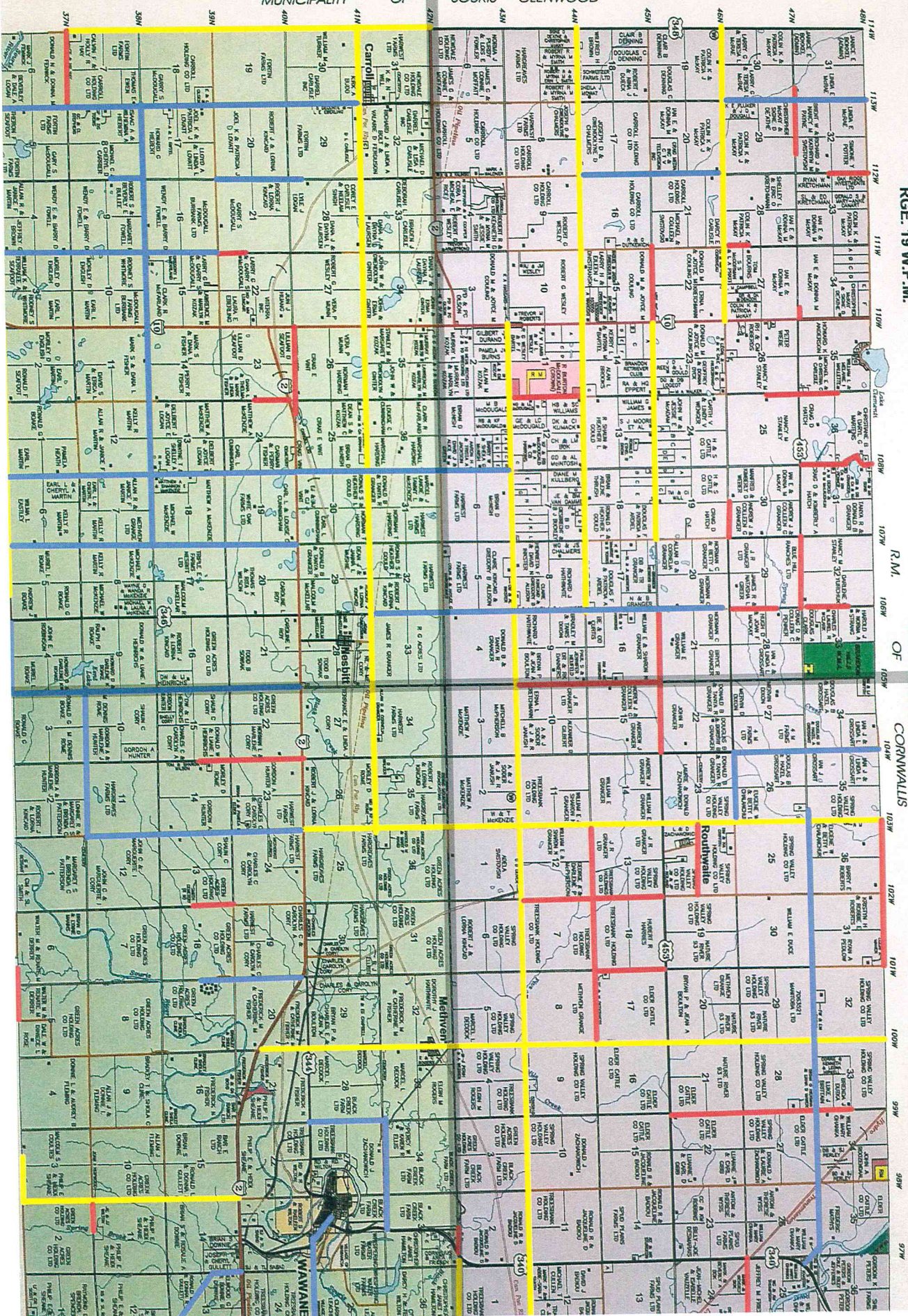

Gravel hauling costs for roads @ 175 yds/mile

Gravel Section #1 (North West)			
Miles to gravel	20	Municipal Pit	19
Yards per mile	175	Cost/yard loaded mile	\$ 0.33
Loads per mile	7	Total Yards Loaded	3500
Total loads	140	Total Loading Costs	\$ 2,625.00
Loaded Miles	2660		
Projected Hauling Cost	\$ 21,812.00		

Gravel Section #2 (South West)			
Miles to gravel	18	Leachman Pit	20
Yards per mile	175	Cost/yard loaded mile	\$ 0.33
Loads per mile	7	Total Yards Loaded	3150
Total loads	126	Total Loading Costs	\$ 2,362.50
Loaded Miles	2520		
Projected Hauling Cost	\$ 20,664.00		

Gravel Section #3 (North East)			
Miles to gravel	22	Municipal Pit	8
Yards per mile	175	Cost/yard loaded mile	\$ 0.33
Loads per mile	7	Total Yards Loaded	3850
Total loads	154	Total Loading Costs	\$ 2,887.50
Loaded Miles	1232		
Projected Hauling Cost	\$ 10,102.40		

Gravel Section #4 (South East)			
Miles to gravel	11	Leachman Pit	13
Yards per mile	175	Cost/yard loaded mile	\$ 0.33
Loads per mile	7	Total Yards Loaded	1925
Total loads	77	Total Loading Costs	\$ 1,443.75
Loaded Miles	1001		
Projected Hauling Cost	\$ 8,208.20		

Total Cost	\$ 70,105.35
Total Yards	12425
Total Miles	71
Percent	32.5%

Contractor Costs	
Hauling cost/loaded mile	\$ 0.328
Loading cost/yard	\$ 0.75

Gravel hauling costs for roads @ 100 yds/mile

Gravel Section #1 (North West)			
Miles to gravel	17	Municipal Pit	19
Yards per mile	100	Cost/Yard loaded mile	\$ 0.33
Loads per mile	4	Total Yards Loaded	1700
Total loads	68	Total Loading Costs	\$ 1,275.00
Loaded Miles	1292		
Projected Hauling Cost	\$ 10,594.40		

Gravel Section #2 (South West)			
Miles to gravel	29	Leachman Pit	20
Yards per mile	100	Cost/Yard loaded mile	\$ 0.33
Loads per mile	4	Total Yards Loaded	2900
Total loads	116	Total Loading Costs	\$ 2,175.00
Loaded Miles	2320		
Projected Hauling Cost	\$ 19,024.00		

Gravel Section #3 (North East)			
Miles to gravel	26	Municipal Pit	8
Yards per mile	100	Cost/Yard loaded mile	\$ 0.33
Loads per mile	4	Total Yards Loaded	2600
Total loads	104	Total Loading Costs	\$ 1,950.00
Loaded Miles	832		
Projected Hauling Cost	\$ 6,822.40		

Gravel Section #4 (South East)			
Miles to gravel	17	Leachman Pit	13
Yards per mile	100	Cost/Yard loaded mile	\$ 0.33
Loads per mile	4	Total Yards Loaded	1700
Total loads	68	Total Loading Costs	\$ 1,275.00
Loaded Miles	884		
Projected Hauling Cost	\$ 7,248.80		

Total Cost	\$ 50,364.60
Total Yards	8900
Total Miles	89
Percent	40.7%

Contractor Costs	
Hauling cost/loaded mile	\$ 0.328
Loading cost/yard	\$ 0.75

RGE. 19 W.P.M.

R.M.

RGE. 18 W.P.M.

CORNWALLIS

RGE. 17 W.P.M.

MUNICIPALITY OF SOURIS - GLENWOOD

WP. 8

WP. 7

